

| LEGEND | | | |
|----------|--------|----------|---------------------------------------|
| EXISTING | FUTURE | ULTIMATE | ITEM |
| --- | --- | --- | FEE PROPERTY |
| PHOTO | --- | --- | AIRFIELD PAVEMENT |
| PHOTO | --- | --- | AUTOMOBILE PAVEMENT |
| PHOTO | --- | --- | HANGARS/BUILDINGS |
| N/A | --- | --- | PAVEMENT REMOVAL |
| PHOTO | --- | --- | BUILDING REMOVAL |
| --- | --- | --- | RUNWAY SAFETY AREA (RSA) |
| --- | --- | --- | RUNWAY OBJECT FREE AREA (OFA) |
| --- | --- | --- | RUNWAY OBJECT FREE ZONE (OFZ) |
| --- | --- | --- | TAXIWAY SAFETY AREA (TSA) |
| --- | --- | --- | TAXIWAY OBJECT FREE AREA (TOFA) |
| --- | --- | --- | DEPARTURE SURFACE |
| --- | --- | --- | PAPI OBSTACLE CLEARANCE SURFACE (OCS) |
| --- | --- | --- | RUNWAY VISIBILITY ZONE (RVZ) |
| --- | --- | --- | 35' BUILDING RESTRICTION LINE (BRL) |
| --- | --- | --- | BEACON |
| --- | --- | --- | LIGHTED WIND CONE |
| --- | --- | --- | ASOS |
| --- | --- | --- | PAPIS |
| --- | --- | --- | FENCE |
| --- | --- | --- | GROUND CONTOURS |

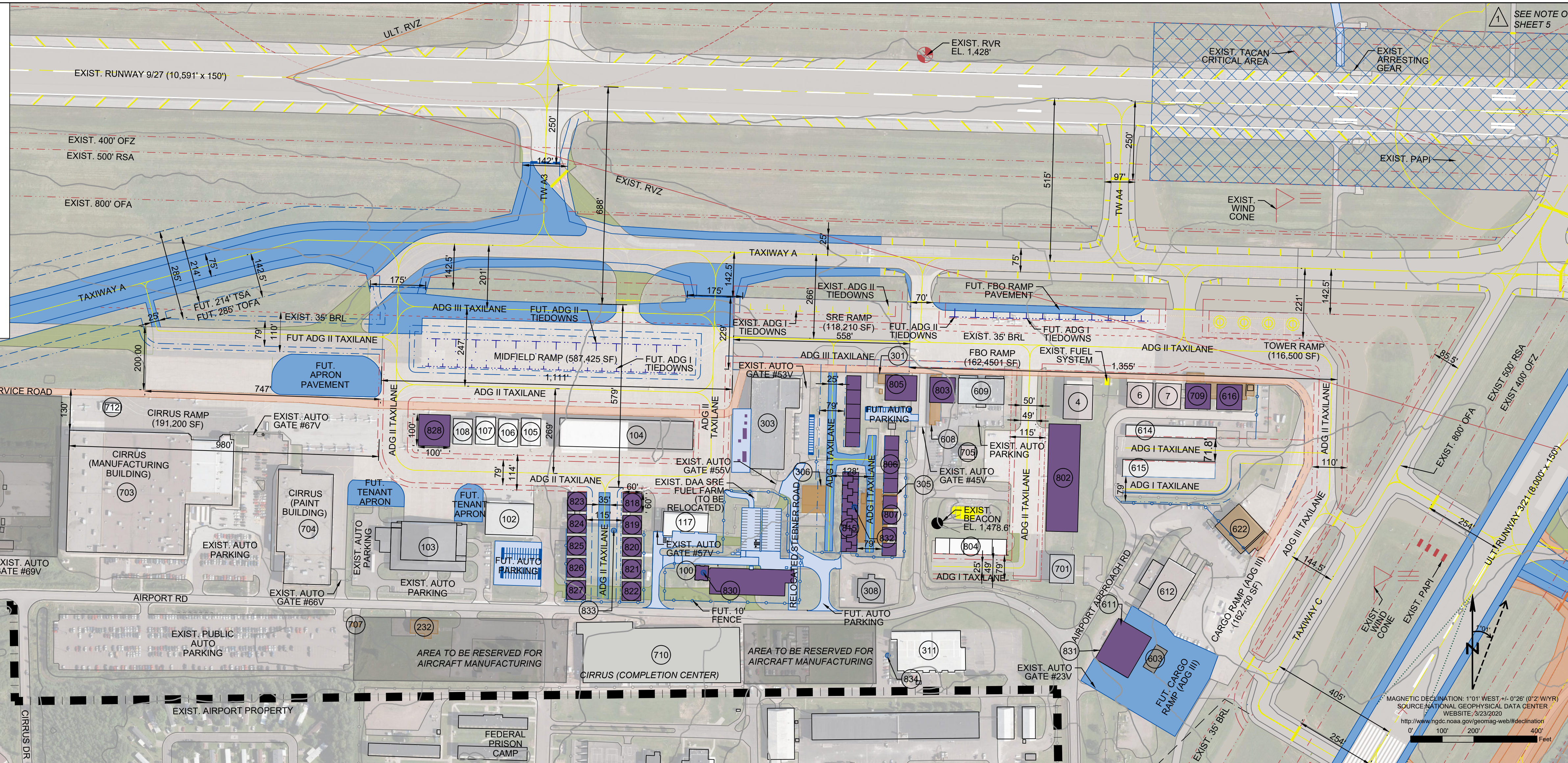

| # | DESCRIPTION | TOP ELEVATION | PENETRATION/CLEARANCE TO 7:1 TRANSITIONAL SURFACE | DISPOSITION |
|-------------|--|---------------|---|---------------|
| 4 | BOX HANGAR | 1,455.0' | 30.4' CLEAR | TO REMAIN |
| 6 | BOX HANGAR | 1,446.1' | 37.4' CLEAR | TO REMAIN |
| 7 | BOX HANGAR | 1,446.2' | 37.4' CLEAR | TO REMAIN |
| 100 | | | | REMOVED |
| 102 | BOX HANGAR | 1,444.9' | 101.2' CLEAR | TO REMAIN |
| 103 | LAKE SUPERIOR COLLEGE | 1,466.3' | 89.4' CLEAR | TO REMAIN |
| 104 (7/8) | BOX HANGAR | 1,468.2' | 38.7' CLEAR | TO REMAIN |
| 104 (9/10) | BOX HANGAR | 1,468.2' | 38.7' CLEAR | TO REMAIN |
| 104 (13/14) | BOX HANGAR | 1,468.2' | 38.7' CLEAR | TO REMAIN |
| 105 | BOX HANGAR | 1,453.1' | 54.3' CLEAR | TO REMAIN |
| 106 | BOX HANGAR | 1,452.0' | 56.0' CLEAR | TO REMAIN |
| 107 | BOX HANGAR | 1,451.6' | 57.8' CLEAR | TO REMAIN |
| 108 | BOX HANGAR | 1,436.5' | 72.1' CLEAR | TO REMAIN |
| 117 | BOX HANGAR | 1,455.5' | 92.4' CLEAR | TO REMAIN |
| 123 | MNANG DRMO WAREHOUSE | 1,450.0' | 65.3' CLEAR | TO BE REMOVED |
| 124 | MNANG LAB / OFFICES | 1,439.6' | 127.2' CLEAR | TO BE REMOVED |
| 125 | MNANG DRMO WAREHOUSE | 1,436.8' | 93.2' CLEAR | TO BE REMOVED |
| 232 | WAREHOUSE | 1,433.9' | - | TO BE REMOVED |
| 301 | EMERGENCY GENERATOR / ELECTRICAL VAULT | 1,437.2' | 45.7' CLEAR | TO BE REMOVED |
| 303 | SRE MAINTENANCE GARAGE | 1,461.1' | 24.4' CLEAR | TO REMAIN |
| 305 | MANUFACTURING FACILITY | 1,440.6' | 94.6' CLEAR | TO BE REMOVED |
| 306 | DULUTH AIRPORT AUTHORITY SRE | 1,455.4' | 79.0' CLEAR | TO BE REMOVED |
| 308 | OFFICE BUILDING | 1,443.2' | 130.5' CLEAR | TO BE REMOVED |
| 311 | MANUFACTURING / STORAGE | 1,456.0' | 114.7' CLEAR | TO REMAIN |
| 603 | AIRPORT COLD STORAGE | 1,439.7' | 57.1' CLEAR | TO BE REMOVED |
| 608 | T-HANGAR (5-UNIT) | 1,434.6' | 48.0' CLEAR | TO BE REMOVED |
| 609 | FBO (MAINTENANCE / HANGARS - 2 UNITS) | 1,452.5' | 30.0' CLEAR | TO REMAIN |
| 611 | OLD SRE / FBO STORAGE FACILITY | 1,444.7' | 61.2' CLEAR | TO BE REMOVED |

| # | DESCRIPTION | TOP ELEVATION | PENETRATION/CLEARANCE TO 7:1 TRANSITIONAL SURFACE | DISPOSITION |
|-----|--|---------------|---|---------------|
| 612 | FEDEX - HANGAR (SORT FACILITY) | 1,437.2' | 66.4' CLEAR | TO REMAIN |
| 614 | HANGAR (RANCH HANGARS - 7 UNITS) | 1,428.1' | 74.8' CLEAR | TO REMAIN |
| 615 | T-HANGAR (13-UNIT) | 1,433.4' | 84.9' CLEAR | TO REMAIN |
| 616 | FAA ATC TOWER / CLASSROOM SPACE / OFFICE | 1,467.8' | 14.9' CLEAR | TO BE REMOVED |
| 622 | MUNICIPAL HANGAR #2 - STORAGE FACILITY | 1,445.1' | 37.6' CLEAR | TO BE REMOVED |
| 701 | BOX HANGAR | 1,444.1' | 104.8' CLEAR | TO REMAIN |
| 703 | CIRRUS (MANUFACTURING FACILITY) | 1,454.5' | 63.4' CLEAR | TO REMAIN |
| 704 | CIRRUS (MANUFACTURING / PAINT FACILITY) | 1,470.7' | 62.9' CLEAR | TO REMAIN |
| 705 | GARAGE | 1,445.7' | 68.4' CLEAR | TO REMAIN |
| 707 | STORAGE FACILITY | 1,426.5' | - | TO BE REMOVED |
| 709 | FAA GARAGE / STORAGE | 1,428.4' | 50.1' CLEAR | TO BE REMOVED |
| 710 | CIRRUS FINISHING CENTER | 1,455.5' | - | TO REMAIN |
| 711 | WEST GARAGE | 1,430.1' | - | TO REMAIN |
| 712 | CIRRUS RUN UP GARAGE | 1,439.4' | 65.8' CLEAR | TO REMAIN |
| 804 | RANCH HANGARS | 1,439' EST. | 117.2' CLEAR EST. | TO REMAIN |

| ALTERNATIVE ATCT SITES CONSIDERED IN AFTIL 1 AND 2 PROCESS | | | | |
|--|---|---------------|---|------------------|
| # | DESCRIPTION | TOP ELEVATION | PENETRATION/CLEARANCE TO 7:1 TRANSITIONAL SURFACE | DISPOSITION |
| 832 | AFTIL ATCT SITE 3 (N46° 50' 17.39" W092° 11' 40.66") | 1,572' EST. | 38.2' PENETRATION EST. | TO BE CONSIDERED |
| 833 | AFTIL ATCT SITE NUMBER 4 (N46° 50' 16.74" W092° 11' 51.62") | 1,585' EST. | 37.5' PENETRATION EST. | TO BE CONSIDERED |
| 834 | AFTIL ATCT SITE NUMBER 7 (N46° 50' 12.73" W092° 11' 39.21") | 1,589' EST. | 11.6' CLEAR EST. | TO BE CONSIDERED |

| # | DESCRIPTION | TOP ELEVATION | PENETRATION/CLEARANCE TO 7:1 TRANSITIONAL SURFACE | DISPOSITION |
|---------|---|---------------|---|-------------------|
| 802 | MULTI-UNIT BOX HANGAR (OR INDIVIDUAL HANGARS WITHIN FOOTPRINT) | 1,461' EST. | 42.4' CLEAR EST. | TO BE CONSTRUCTED |
| 803 | BOX HANGAR | 1,452' EST. | 30' CLEAR EST. | TO BE CONSTRUCTED |
| 805 | RANCH HANGAR | 1,452' EST. | ≥30.9' CLEAR EST. | TO BE CONSTRUCTED |
| 806 | RANCH HANGAR (OR INDIVIDUAL HANGARS WITHIN FOOTPRINT) | 1,452' EST. | ≥56.6' CLEAR EST. | TO BE CONSTRUCTED |
| 807 | RANCH HANGAR | 1,452' EST. | ≥56.6' CLEAR EST. | TO BE CONSTRUCTED |
| 815 | T-HANGAR (14-UNIT) | 1,442' EST. | 88.6' CLEAR EST. | TO BE CONSTRUCTED |
| 816 | RANCH HANGARS | 1,446' EST. | 87.5' CLEAR EST. | TO BE CONSTRUCTED |
| 818-822 | BOX HANGARS | 1,452' EST. | ≥88.0' CLEAR EST. | TO BE CONSTRUCTED |
| 823-827 | BOX HANGARS | 1,452' EST. | ≥88.0' CLEAR EST. | TO BE CONSTRUCTED |
| 828 | BOX HANGAR | 1,456' EST. | 51.0' CLEAR EST. | TO BE CONSTRUCTED |
| 829 | FUTURE BUILDING AREA DEVELOPMENT | - | - | TO BE CONSTRUCTED |
| 830 | PREFERRED ATCT SITE - AFTIL SITE 6 (N46° 50' 15.39" W092° 11' 47.56") | 1,578' EST. | 12.6' PENETRATION EST. | TO BE CONSTRUCTED |
| 831 | CARGO SORT FACILITY | 1,435' EST. | 66.4' CLEAR EST. | TO BE CONSTRUCTED |

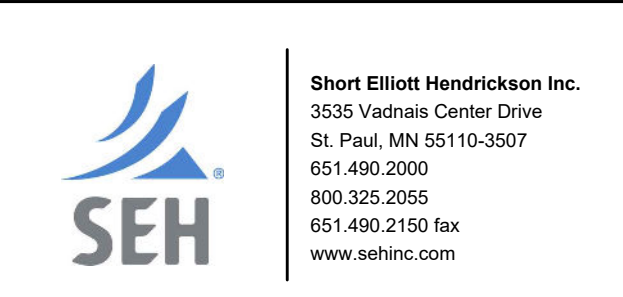

DULUTH INTERNATIONAL AIRPORT
DULUTH, MINNESOTA
AIRPORT LAYOUT PLAN
© 2025 Short Elliott Hendrickson Inc.

| NO. | MARK | DATE | DESCRIPTION |
|-----|------|------|-------------|
| | | | |
| | | | |
| | | | |
| | | | |

DESIGNER: MSS
DRAWN BY: MLM
QA/QC: KMN
DESIGN TEAM

TERMINAL PLAN - SOUTHWEST DEVELOPMENT AREA

AIP NO. 3-27-0024-064-2019 SEH FILE NO. DULA1 150733 DATE: JUNE 10, 2025