

LEGEND			
EXISTING	FUTURE	ULTIMATE	ITEM
	SAME	SAME	FEE PROPERTY
	SAME	SAME	AVIGATION EASEMENT
			AIRFIELD PAVEMENT
			AUTOMOBILE PAVEMENT
			HANGARS/BUILDINGS
			PAVEMENT REMOVAL
	SAME		RUNWAY SAFETY AREA (RSA)
	SAME		RUNWAY OBJECT FREE AREA (OFA)
	SAME		RUNWAY OBJECT FREE ZONE (OFZ)
	SAME		TAXIWAY OBJECT FREE AREA (TOFA)
	SAME		FAA RUNWAY PROTECTION ZONE (RPZ)
	SAME		MNDOT CLEAR ZONE
	SAME		14 CFR PART 77 APPROACH SURFACE
	SAME		FAA-13B APPROACH SURFACE
	SAME		PAPI OBSTACLE CLEARANCE SURFACE (OCS)
	SAME		RUNWAY VISIBILITY ZONE (RVZ)
	SAME		35' BUILDING RESTRICTION LINE (BRL)
	SAME		PAPIS
	SAME		REILS
	SAME		8' FENCE
	SAME		GROUND CONTOURS

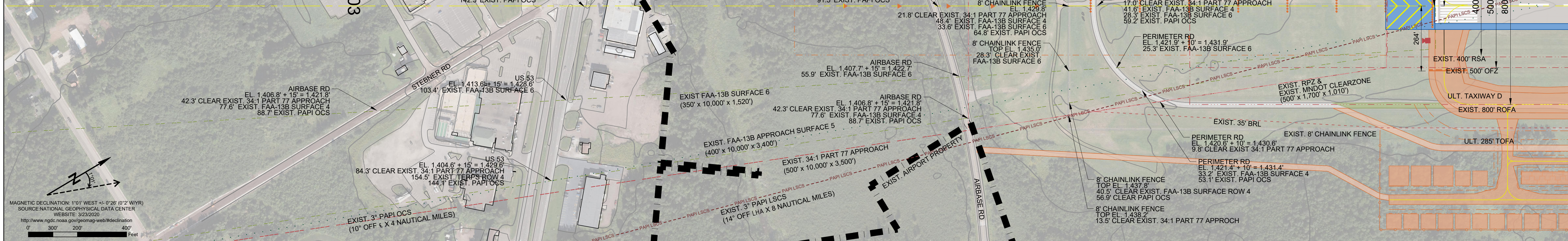

PROFILE LEGEND

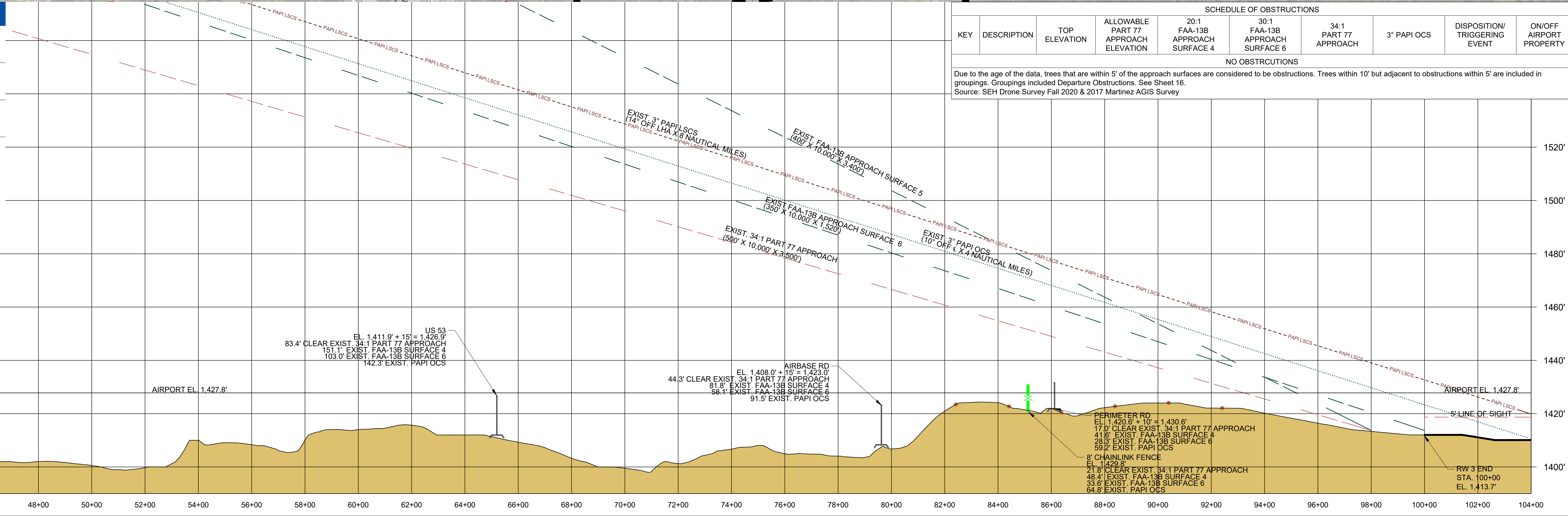
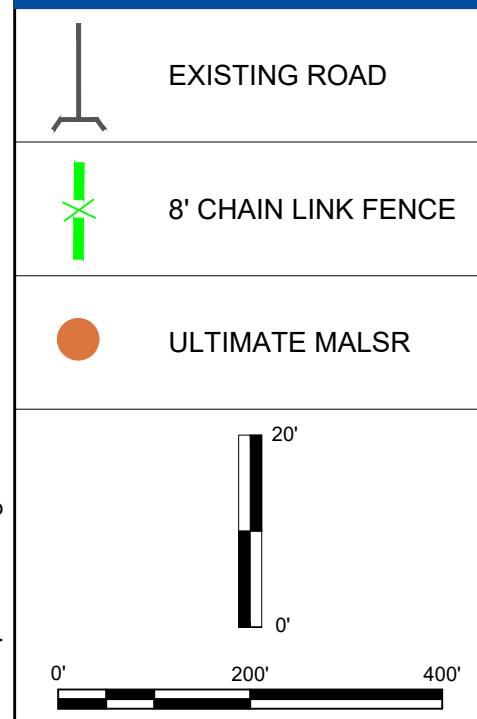

SCHEDULE OF OBSTRUCTIONS									
KEY	DESCRIPTION	TOP ELEVATION	ALLOWABLE PART 77 APPROACH ELEVATION	20:1 FAA-13B APPROACH SURFACE 4	30:1 FAA-13B APPROACH SURFACE 6	34:1 PART 77 APPROACH	3' PAPI OCS	DISPOSITION/TRIGGERING EVENT	ON/OFF AIRPORT PROPERTY
NO OBSTRUCTIONS									
Due to the age of the data, trees that are within 5' of the approach surfaces are considered to be obstructions. Trees within 10' but adjacent to obstructions within 5' are included in groupings. Groupings included Departure Obstructions. See Sheet 16. Source: SEH Drone Survey Fall 2020 & 2017 Martinez AGIS Survey									

DULUTH INTERNATIONAL AIRPORT
DULUTH, MINNESOTA

AIRPORT LAYOUT PLAN

© 2025 Short Elliott Hendrickson Inc.

NO.	MARK	DATE	DESCRIPTION
REVISIONS			

DESIGNER: MSS
DRAWN BY: MLM
QA/QC: KMN
DESIGN TEAM

EXISTING & FUTURE RUNWAY 03 APPROACH

SHEET NO. 13 of 35

AIP NO. 3-27-0024-064-2019 SEH FILE NO. DULAI 150733 DATE: JUNE 10, 2025